

S E C R E T

Classification changed to

RESTRICTED by auth of

CO AAF Sta 128 by
JACKSON M. PHIPPS,
Captain, Air Corps
Adjutant.

REPORT OF OPERATIONAL DAY

MISSION NO.135
26TH. AUGUST, 1944

94TH. COMBAT BOMB WING
401ST. BOMBARDMENT GROUP (H)

MISSION NO. 135

To:

LA LOUVIERRE, BELGIUM &

TERTRE, BELGIUM

401ST BOMBARDMENT GROUP (H)

R E P O R T O F O P E R A T I O N A L
D A Y

MISSION SUMMARY REPORT

MISSION # 135

Date 26 August 1944

ASSIGNMENT

1. Assigned Target: TERTIE & LA LOUVIERRE, BELGIUM
2. Commitments: The 401st furnished two 12 A/C boxes, Forces "A" and "B" for the 94th Wing. No PFF nor spares were to accompany mission. Each box having a separate target.

EXECUTION

1. Target Bombed: None
2. a. Force "A" Leader: Capt. F. A. KALINSKI
 Lead Navigator: 2nd Lt. E. F. RUSSELL (Taylor)
 Lead Bombarider: 2nd Lt. C. K. MINOTT
- b. Force "B" Leader: Capt. J. A. GRUMAN
 Lead Navigator: 1st Lt. J. GRISET
 Lead Bombarider: 1st Lt. R. J. ANDREWS
3. Flight Over England:
 - a. Takeoff: Takeoff was without incident.
 - b. Group and Wing Assemblies: Upon departure from King's Cliffe buncher there were three 12 ship boxes. Departure from King's Cliffe buncher was made two minutes late.
 - c. Route Over England: The remainder of the flight over England was as briefed. Departure from point "Z" was made two minutes early.
4. Attack:
 - a. Flight to Target: There was no Division formation. The 94th "A", "B" and "C" force penetrated the coast as a Wing and then peeled off as briefed to their respective targets.

MISSION SUMMARY REPORT (Cont)

b. Bombing Run:

Lead Force: Cloud cover was 6/10-10/10ths variable. IP on first run was visible only momentarily (see by Navigator). We were unable to find target or any check points on first run also unable to distinguish between rail roads, canals and auto-bahns due to heavy haze and thin alto-stratus clouds with rain at altitude of 15,000' to 17,000'. The force made a 360° to right and attempted second run. We turned on Gee Navigators advice at same altitude (20,000'). The Navigator identified one forest above IP after turning. From there on in we used "Gee" with Navigator calling off distances to target. We were unable to see any thing and to be certain of any railroad, canal etc. Visibility was from 1/2 mile to 3 miles. Bombs not dropped due to the above conditions. (The Bombardier did the best he could and so did the Navigators)

Force "B": Same general conditions as above, all bombs were returned.

c. Flight From Target: There was no Wing formation on return. The journey back was without incident.

d. Return to Base: Return to Base was as briefed, all ships landing safely at home base.

e. Weather: Weather enroute was 2-3/10ths cumus over the channel at about 20,000 feet, remaining the same over the target area. Low cloud was 6-8/10ths over the target area with 10/10ths coverage over most of the route except over the channel.

f. Fighter Support: Fighter support made rendezvous on time and was apparent at all times.

g. Conclusions and Recommendations: None

5. Aircraft Not Attacking:

All aircraft airborne did not attack.

6. Enemy Opposition: None

7. Battle Damage: None

8. Casualties: None

9. Statistical Summary of Operations (see attached form)

MISSION SUMMARY REPORT (Cont)

10. Bombing Data:

a. Disposition of Bombs:

Force "A": 12 A/C returned 130 x M64 to base.

Force "B": 12 A/C returned 138 x M64 to base.

b. Observations:

No Bombs were dropped.

c. Tabular Summary of Disposition of Bombs:

	Aircraft		Bombs				
	Over Target	Bomb- ing	Num- ber	Size	Type	Fusing Nose Tail	
Main Bombfall	24	0	-	-	-	-	-
Other Attacks	-	-	-	-	-	-	-
Total Bombs On Targets	-	-	-	-	-	-	-
Other Expenditures	-	-	-	-	-	-	-
Bombs Returned			128	500#	GP	1/10	1/40
			140	500#	RDX	1/10	1/40
Total (Loaded on A/C Taking Off)			128	500#	GP	1/10	1/40
			140	500#	RDX	1/10	1/40

11. Lost Aircraft:

None.

Submitted By:

KEN W. DAUBLE
 Captain, Air Corps
 Statistical Officer

STATISTICAL SUMMARY OF OPERATIONS

401st Group

1st BD F. O. 480

Date of 26 August 1944

	"A" Force		"B" Force	
		PFF - GH		PFF - GH
1. No. of A/C Failing to Take Off	-		-	
2. No. of A/C Airborne	12		12	
3. No. of A/C Airborne Less Spares	12		12	
4. No. of A/C Sorties	12		12	
5. No. of A/C Attacking	-		-	
6. No. of A/C Not Attacking	12		12	
(a) Early Returns Included				
7. Name of Primary Target	NOT ATTACKED			
(a) No of A/C Attacking				
(b) No., Size & type of bombs				
8. Name of Secondary Target	NONE			
(a) No of A/C Attacking				
(b) No., Size & type of Bombs				
9. Name of Last Resort Target	NONE			
(a) No. of A/C Attacking				
(b) No., Size & type of Bombs				
10. Name of Target of Opportunity	NONE			
(a) No. of A/C Attacking				
(b) No., Size, & type of Bombs				
11. Name of Target Opportunity	NONE			
(a) No. of A/C Attacking				
(b) No., Size & type of Bomb				
12. No of A/C Lost - TOTAL				
13. - to Flak				
14. - to Flak & E/A				
15. - to Enemy A/C				
16. - to Accident				
17. - to Unknown				

STAT SUMMARY (Cont'd)

	"A" Force	"B" Force
18. Time of Takeoff	1452	1453
19. Time of Attack	-	-
20. Average Time of Flight	4.6	4.7
21. Altitude of Release	-	-
22. Visual or PFF	-	-
23. Enemy Resistance - AA Int.&ACC.	NONE	NONE
24. - Fighters	NONE	NONE
25. - Bombers	NONE	NONE
26. U.S. A/C Engaged by Enemy A/C	NONE	NONE
27. Degree of Success	-	-

PFF A/C Borrowed from Groups as follows:

NONE

PFF A/C Loaned to Groups as Follows:

NONE

NOTES:

~~Combat Flight Leader~~ CAPT. KALINSKI Date 26 August 1944

~~Deputy Flight Leader~~ LT. MANNIX

613 SQDN

612th SC JABWOCK
613th IN MACRO
614th IW GOLFCLUB
615th IY BUZZARD

KALINSKI

IW R 7780

401st Lead Box, "A" Force
at take-off, Cruise, and over
Target.

KEELING

MANNIX

IW G 1081

IW R 6113

614 SQDN

615 SQDN

KOVACH

IW J 2659

KOZZE

IW S 6145

BRIGHT

IW O 7602

EVANS

IW H 7869

COOPER

SC P 1891

CALLAWAY

IW Z 8330

FILSMYR

IW S 2947

MAYS

IW G 7084

KOONS

IW F 7395

SPARES

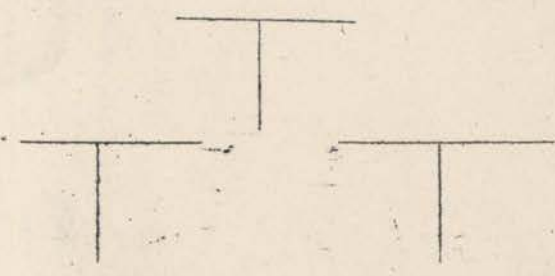

~~Combat Flight Leader~~ CAPT. GRUMAN Date 26 August 1944

~~Deputy Flight Leader~~ LT. MERCER

614th SQDN

612th SC JABWOCK
613th IN MACRO
614th IW GOLFCLUB
615th IY BUZZARD

GRUMAN

IY D 8125

401st Low Box "B" Force
at Take-Off, Cruise, and over
Target.

MOHLER

MERCER

SC R 2393

SC L 7632

612th SQDN

615th SQDN

TOUSSAINT

SC A 7628

DOW

IY O 1091

HARLAN

SC H 2398

GIBSON

SC G 9993

UDY

IY C 2468

WINGARD

IY Q 8077

LOUGHLIN

SC J 7790

GROMER

SC E 1662

LINDSEY

SC M 7039

SPARES

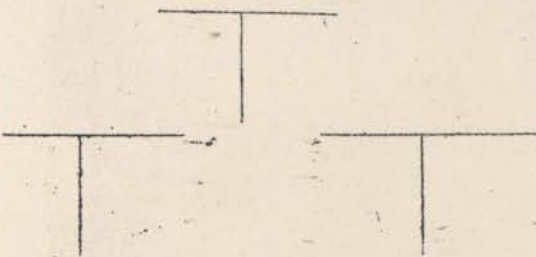

HEADQUARTERS AAF STATION #128
 OFFICE OF THE NAVIGATION OFFICER

26 August 1944

SUBJECT: Lead Navigator's Narrative

TO : Commanding Officer, 401st Bombardment Group (H)

1. Flight plan, Log, and Track Chart Attached.

2. Narrative:

a. T/O at 1452 hours; Land at 1948 hours.

b. Group formed at 1558 hours at 12,000 feet.

c. Formed CBW at 1558 hours at 12,000 feet.

d. Began climb at 1559 hours; reached alt. at 1705 hours.

e. Weather encountered over England:

(1) Clouds 7 / 10th - Visability 5 miles.

(2) Wind at altitude 190 degrees, 16 Knots.

f. Means of navigation over England. Gee, Pilotage, D.R.

g. Means of checking Metro Winds Gee

h. Joined task force at _____ hrs. at _____
 (Splasher, City, Coord.)

i. English Coast out at 1633 hrs.; Enemy Coast in at 1701 $\frac{1}{2}$ hrs.

j. Fighter Rendezvous:

(1) Going in 1700 hrs.

(2) Coming back 1815 hrs.

k. Wind used for bombing:

(1) _____ Bombs not released
 _____ degrees, _____ Knots.

(2) Determined by _____
 (Method)

l. Bomb run and Method of Target Identification:

(1) Reached IP at 1741 & 1812 hrs.

(2) Mag. heading over target 33 degrees.

(3) Altitude over target 20,000 feet.

(4) Bombs away at _____ hrs.

(5) Method of target identification and weather over target.

Haze, 3 layers of cloud, could not see target.

m. Gee:

(1) Coordinates of furthest fix 50-45 N. 04-08 E.

(2) Obtained at 1823 hours.

n. Difficulties encountered with special equipment.

COMMENTS: Did 360° to make another
 run on target; went back to I.P.

/S/ W. F. Russell
 W. F. RUSSELL
 1st Lt., A. C.
 Lead Navigator

FLIGHT PLAN

PILOT Lt. Kalinski NAVIGATOR Lt. W. F. Russel DATE 26 August 1944

STATIONS 1330 ENGINES 1430 TAXI 1445 T.O. 1500
LEAVE BASE KING'S CLIFF 1601
COAST OUT 1635
ENEMY COAST 1704
I.P. 1745
TARGET 1753
ENEMY COAST 1818
ENGLISH COAST 1845
ETR 1914

SUN		MOON		TWILIGHT	
Rises	Sets	Rises	Sets	AM	PM

Zero Hr - 1800

WATCH Fast Slow RATE secs/hour Gaining Losing
 At G.M.T. Letdown on Cottasmore Lead 360 Low 345

FROM TO	W/V UESD	HEIGHT	I.A.S. MPH /K	T.A.S. (K)	COURSE	DRIFT	TRUE HDNG.	VAR.	MAG. HDNG.	C. S.	DIST.	TIME	E.T.A.	CELESTIAL DATA			
														TIME	BODY	ALT.	AZI.
King's Cliff Peterborough	04/17	12M	150	159	88	4	94	10	104	165	9	03 1/2	1557				
"	03/18	13M -1	150	160	65	4	69	10	79	173	26	09	1610				
King's Lynn	01/19	15M -2	150	165	160	5	165	10	175	150	33	13	1623				
Bury St. Edmonds	00/20	15M -6	150	167	106	7	113	10	123	167	33	12	1635	English Coast			
Orfordness	95/22	20M -10	150	174	104	11	115	9	124	173	84	29	1704	Enemy Coast			
51-44N 03-46E	90/25	20M -15	150	182	154	5	159	8	167	162	25	09	1713				
"	"	"	"	"	209	-2	207	8	215	158	60	23	1736				
50-18N 03-20E	"	"	"	"	115	8	123	8	131	173	26	09	1745	I. P.			
50-07N 03-57E	"	"	"	"	43	5	48	8	56	202	27	08	1753	Target, Lead			
T 50-29N 04-11E	"	"	"	"	325	-5	320	8	328	200	29	09	1802				
50-50N 04-00E	"	"	"	"	005	0	005	8	013	208	32	09	1811				
51-22N 04-03E	"	"	"	"	334	-5	329	8	337	202	25	07	1818				
51-44N 03-46E	90/17	10M -5	170	190	284	-5	279	9	288	192	84	27	1845				
Orfordness	70/10	2M 10	170	164	288	-3	285	10	295	168	82	29	1914				
Base																	
50-18N 03-20E	90/25	20M	150	182	126	7	133	8	141	170	17	06	1736	I. P.			
50-08N 03-41E	"	"	"	"	11	0	11	8	19	206	21	06	1748	Target			
50-29N 03-48E	"	"	"	"	320	-6	314	8	322	196	11	03 1/2	1752				
50-36N 03-38E	"	"	"	"	21	2	23	8	31	206	49	14	1806	5 min early			

FLIGHT RECORD

TIME	COURSE	W/V USED &/OR D.R. DRIF.	TRUE HDNG.	MAG. HDNG.	NAVIGATIONAL OBSERVATION	GENERAL OBSERVATION	I.A.S. MPH /K	HEIGHT & AIR TEMP.	T.A.S.	RUN		G. S.	TO RUN		E.T.A.
										DIST.	TIME		DIST.	TIME	
					Target	Lead - 50-29N 04-11E Low - 50-29N 03-48E Second run ok. "A" - Abandon ops - "Paris by Sunday" "B" - " " - "Warsaw by September"									
					Engines 1429	Take off 1452									
1520					Circling Kings Cliff		150	12000	160						
1559	85	45	90		Departing Kings Cliff On course 2 min late		150	12000	160						
1602	60	45	65		Peterborough 1 min late 4 mi south		150	13000	161			173	20	09	1611
1610					Kings Lynn On time 5 mi South		150	13000	161						
1615	180	0	180		51 35N 00 40E (Gee)		150	13000	161						
1623	106	47	113		St. Edmonds On time		150	14000	163			167	33	12	1635
1633		190/16	115		English Coast On Course 2 min early Wind by Gee		150	15000	165						
1636			116		On course 2 minutes early		147	15300				160	52	19 1/2	1704
1641			114		Correct 5° Left 51 58N 02 11E		145	16100							
1645			111		On course 1 1/2 minutes early		148	17000							
1650	104	44	108		51 54N 02 48E		145	17400	169	38	14 1/2	157 1/2	38	14 1/2	1704 1/2

FLIGHT RECORD

TIME	COURSE	W/V USED &/OR D.R. DRIF.	TRUE HDNC.	MAC. HDNC.	NAVIGATIONAL OBSERVATION	GENERAL OBSERVATION	IAS. MPH. /K	HEIGHT & AIR TEMP.	T.A.S.	RUN		C. S.	TO RUN		E.T.A.
										DIST.	TIME		DIST.	TIME	
1655			108		51 48N 03 17 E	On course 1 min early	148	18350 -11							
1701½			159		51 43N 03 45E		145	19300 -13							
1704			159		51 40N 03 52E		148								
1705			156		51 37N 03 52E	On course 2 minutes early	148	20000 -14							
1708			156		1 mi East	2 minutes early (P-51's) High Box Leaves									
1710			183		In turn		144	20000 -15							
1711½		146/19	206		51 23N 04 02E	On course 2 min early Gee Wind	145	20000		24½	9	160			
1718			199		51 07N 03 55E	Going around Ghent	145	20000 -15							
1720			205		50 58N 03 50E	1½ NE of course 1 min early		"							
1723			205		50 55N 03 47E					30	11½	156			
1725			205		50 45N 03 40E		145	20000							
1728			205		50 40N 03 37E	1 Mile East of course 1 minute early	147	20000		45½	16½	165	16	6	1734
1732			207		50 30N 03 30E										
1734					Turning Point										
1737			140		50 15N 03 35E										
1741			23		I.P.										
1819					Target after second run										
1823			340		50 45N 04 08E			20000							
1826			10		50 57N 04 03E		162	19000							
1829					TURNING POINT 51 09N 04 08E		150	19000 -13							
1832			330		51 19N 04 01E		150	19000							
1835			326		51 23N 04 00E										
1837					Turning Point 51 41N 03 50E										
1840	285	-5	280		Enemy Coast	5 miles South fo Course	170	19000				190	84	27	1907
1845	295	-5	290		51 38N 03 20E		170	18000							
1853	290	-5	285		51 50N 02 45E		170	15000							
1907	288	-3	285		English Coast	on course	170	7000				168	82	29	1933
1915			330		"S"ing	to avoid clouds in letdown	170	7000							
1945			280		Base		150	2000							
1948					Landed										
1955					Engines Killed										
					LOG CLOSED										

TRACK CHART

DATE *Aug. 26, 1944*

TARGETS
PRIMARY

La Louviere, Belgium

Green ROUTE FOLLOWED BY *Briefed Crews*

Red ROUTE FOLLOWED BY *4057 B.C.(H)*

"A" Lead



"A" Lead

Red

DECLASSIFIED PER *ND 415003*
BY *202* NARA DATE *1/22/11*

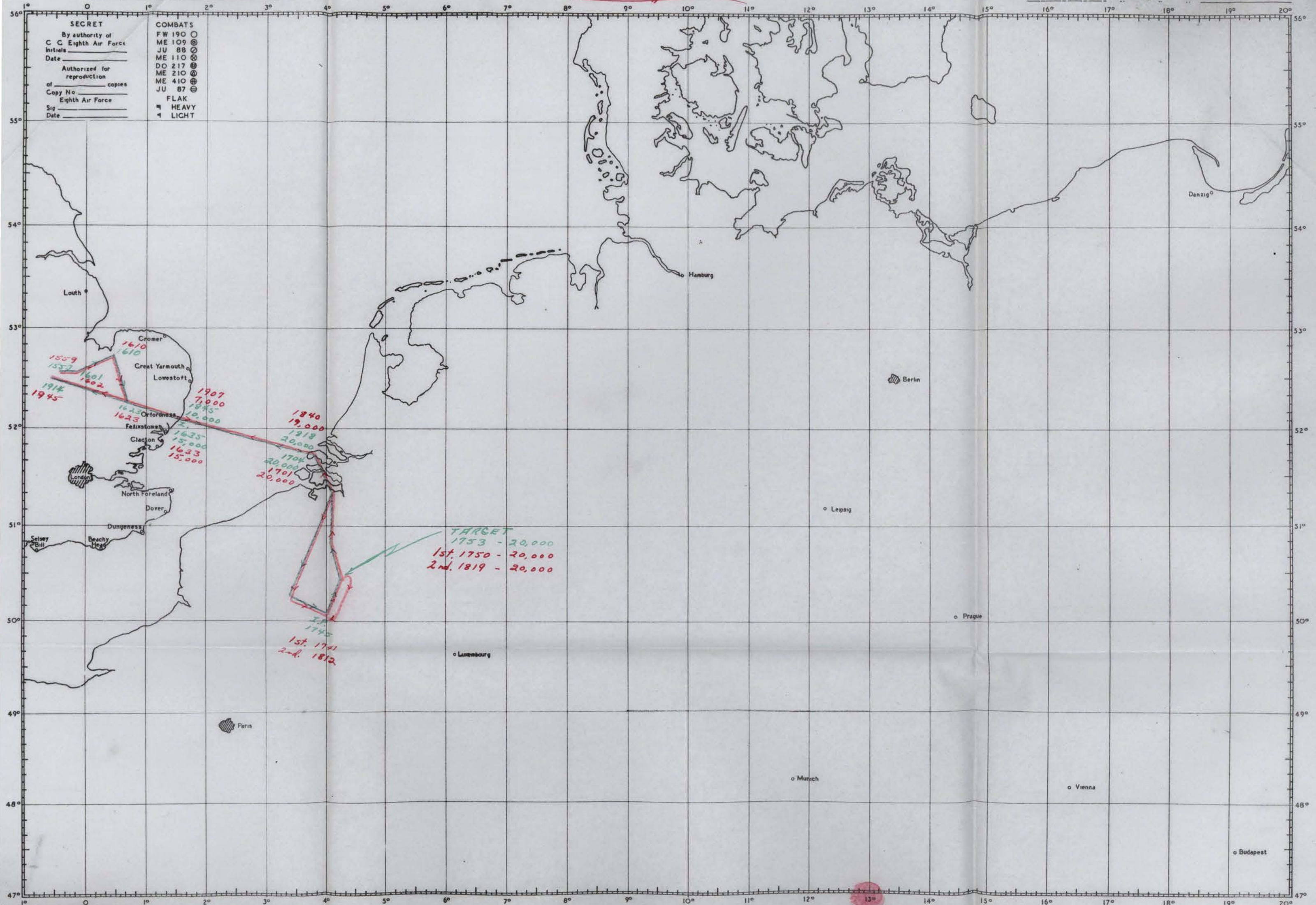

SECRET
By authority of
C C Eighth Air Force
Initials _____
Date _____
Authorized for
reproduction
of _____ copies
Copy No. _____
Eighth Air Force
Sig _____
Date _____

COMBATS
FW 190 ○
ME 109 ⊗
JU 88 ⊗
ME 110 ⊗
DO 217 ⊗
ME 210 ⊗
ME 410 ⊗
JU 87 ⊗
FLAK
HEAVY
LIGHT

TARGET
1753 - 20,000
1st. 1750 - 20,000
2nd. 1819 - 20,000

1st. 1741
2nd. 1812

1

13°

TRACK CHART

DATE *Aug. 26, 1944*

"B" Low

TARGETS
PRIMARY *Tentree, Belgium*

Green ROUTE FOLLOWED BY *Briefed Cars*

Red ROUTE FOLLOWED BY *401st B.C. (H)*

SECRET
By authority of
C C Eighth Air Force
Initials _____
Date _____
Authorized for
reproduction
of _____ copies
Copy No _____
Eighth Air Force
Sig _____
Date _____

COMBATS
FW 190 ○
ME 109 ⊙
JU 88 ⊙
ME 110 ⊙
DO 217 ⊙
ME 210 ⊙
ME 410 ⊙
JU 87 ⊙
FLAK
HEAVY
LIGHT



LOW

1157.0 (11)

SECRET
 By authority of
 C. C. Eighth Air Force
 Initials _____
 Date _____
 Authorized for
 reproduction
 of _____ copies
 Copy No. _____
 Eighth Air Force
 Sig _____
 Date _____

COMBATS
 FW 190 ○
 ME 109 ⊙
 JU 88 ⊙
 ME 110 ⊙
 DO 217 ⊙
 ME 210 ⊙
 ME 410 ⊙
 JU 87 ⊙
 FLAK
 ■ HEAVY
 † LIGHT

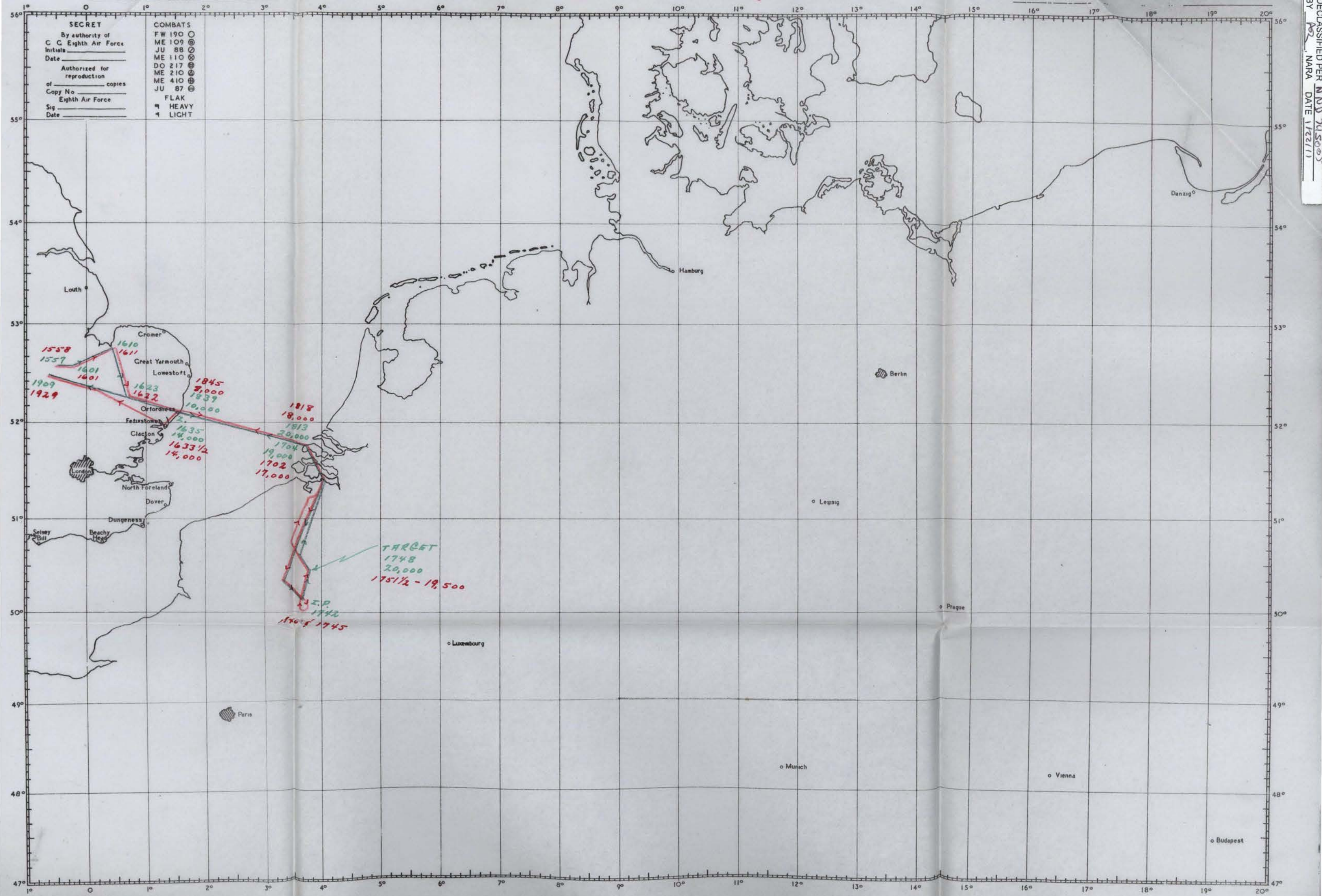

DECLASSIFIED PER NND 715203
 BY SP2 NARA
 DATE 1/22/11

Target No.
S. 5266

STEEL WORKS, COKE OVENS,
Etc.

LA LOUVIERE near CHARLEROI
(BELGIUM)

Illustration No.
S. 5266/1

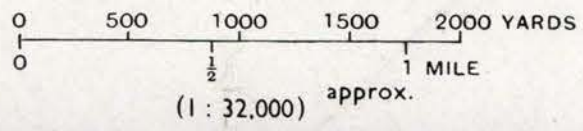

Photographed 9 May 1944

Issued August 1944

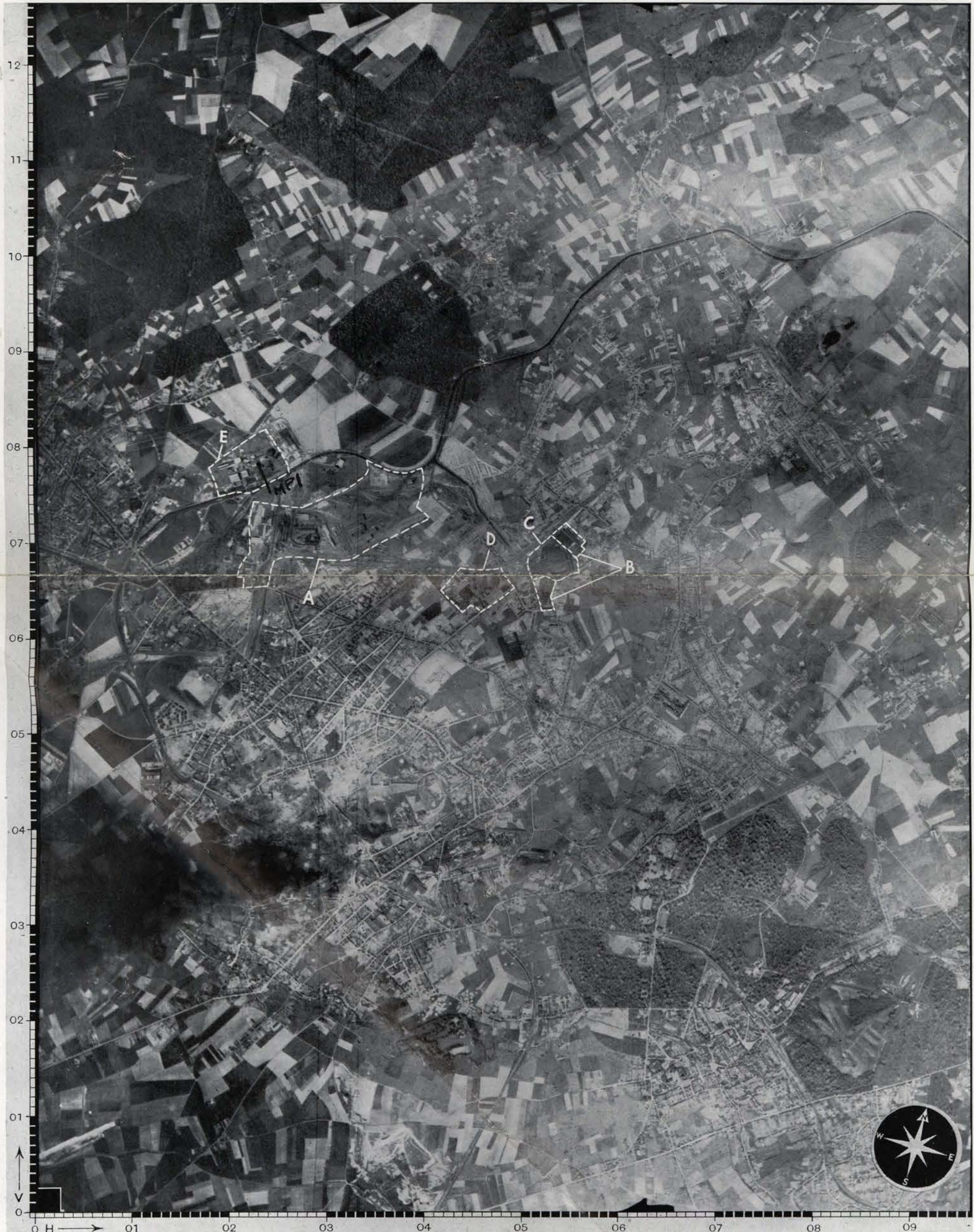

Illustration No.
S. 5266/1

- A. BOEL STEEL WORKS.
- B. THIRLAU STEEL WORKS.
- C. GILSON STEEL WORKS.
- D. LOCOMOTIVE WORKS.
- E. CHEMICAL WORKS.

A.1.3c(1)

TYPE A

FLIGHT RECORD

TIME	COURSE	W/V USED &/OR D.R. DRIF.	TRUE HDNC.	MAC. HDNC.	NAVICATIONAL OBSERVATION	GENERAL OBSERVATION	IAS. MPH. /K	HEIGHT & AIR TEMP	T.A.S.	RUN		C. S.	TO RUN		E.T.A.
										DIST.	TIME		DIST.	TIME	
1718					Ghent, 5 mi. L.		150	18000							
1720					50-58N 03-50E										
1724					50-47N 03-43E										
1751 $\frac{1}{2}$					Target. 10/10 Ac cloud cover target area		150	19500							
1755	21	/2	23		50-36N 03-38E		150	19500	180		204	49	14 $\frac{1}{2}$	1809 $\frac{1}{2}$	
1803 $\frac{1}{2}$					Ghent										
1810	334	-7	327		51-22N 04-03E		150	18000			190	25	08	1818	
1818	281	-8	276		51-42N 03-46E		150	18000			168	84	30	1848	
1820			276		51-44N 03-30E. Starting let down		170 148	12000 72	182						
1832		262/30			51-48N 02-40E				182	36 $\frac{1}{2}$	12				
1832	295	-6	289								156	45	17	1849	
1849	288	-5	283		English Coast, 3 mi L of course.. Turning pt. to drop under cloud cover			6000			154	82	32	1921	
1852	238 305	-8	283 297		51-58W 00-18E		170	4000 16	160		137	83	37	1929	
1900					52-02N 00-52E		150	2000 20	136		112	59	31	1931	
1929					Base										
1930 $\frac{1}{2}$					Land										

SIGNED _____ NAVIGATOR

LEAD BOX

Combat Flight Leader

Date

Deputy Flight Leader

CAPT KALINSKI

26 August 44

*2100
Gas load
Antenna 1330*

SQDN

612th SC JABWOCK

613

613th IN MACRO

KALINSKI

614th IW GOLFCLUB

615th IY BUZZARD

IW R

7780

KEELING

MANLIX

IN C 1081

IN R 6113

SQDN

614

SQDN

615

KOVACH

KONZE

IW J 2659

IW S 6145

BRIGHT

EVANS

COOPER

CALLAWAY

IW O 7602

IW H 7869

SC P 1891

IW Z 8380

PILBRYR

IW S 2947

MAYS

KONS

IW G 7084

IW F 7395

Ground spare IN A 8160

SPARES

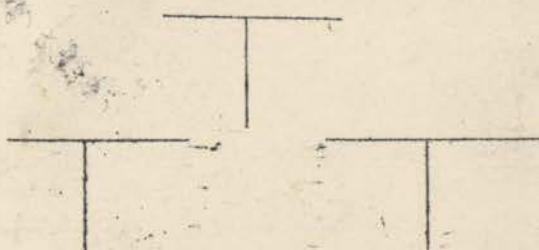

* LOW BOX 94th "A" CBW
#1 CAPT GRUMAN

26 August 44

Combat Flight Leader _____ Date _____
Deputy Flight Leader _____

614th SQUADRON
GRUMAN

- 612th SC JABWOCK
- 613th IN MACRO
- 614th IW GOLFCLUB
- 615th IY BUZZARD

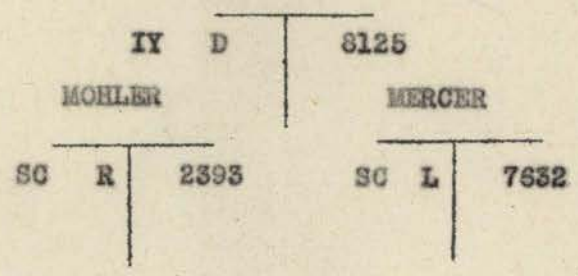

612th SQUADRON

615th SQUADRON

TOUSSAINT

DOW

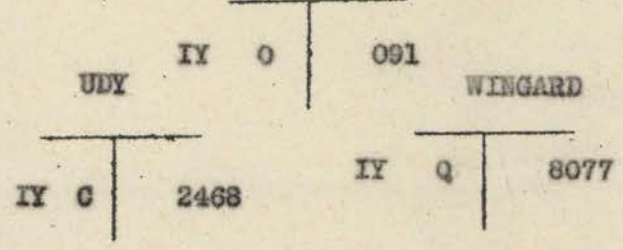
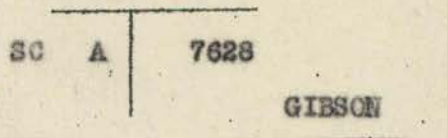

LOUGHLIN

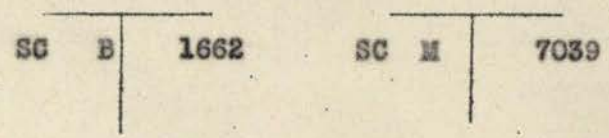
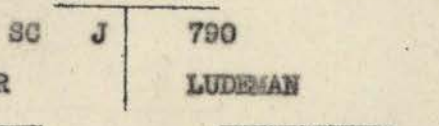

SPARES

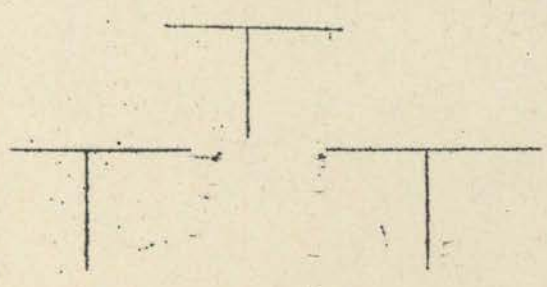

"24 Crews"

Tertre - (5079 - 0348)

Synthetic Ammonia + Benzol
Extraction Plant.

adaptable to production of oxygen -

Nitrogen capacity of 40,000 tons a year

Belgium's largest plant for prod. synth. ammonia

Power - run on Fuel + El. Pl.

MPI - Steam Turbine, Compressor, Boiler, Gas Expansion Plant

La Souveraine (right)

Chemical works (Acetylene Steel + Locomotive
works)

Syn. Ammonia - Nitrogen ^{17,000 tons} adapted
for prod. of pure oxygen

5079 - 0411

MPI - Liquid Oxygen Plant

5-3

OFFICE OF THE OPERATIONS OFFICER
612th Bombardment Squadron (H)
401st Bombardment Group (H)

Plane # 42-37628
APO 557, AAF Station # 123

26 August 1944

SUBJECT: Loading List
TO: Operations Officer, 401st Bombardment Group (H)
APO 557, AAF Station # 123

1. The following is a roster of crews on today's mission.

Plane # 42-102957

P	Carns, Bernhardt F.	1st Lt.	612th
CP	Maupin, Jere W.	Major	"
N	Ligon, Delbert B.	2nd Lt.	"
B	Wiegler, Martin J.	2nd Lt.	"
RO	Vescio, Fred J.	T Sgt	"
TTG	Hester, Richard L.	T Sgt	"
BTG	Doogan, Arthur J. Jr.	S Sgt	"
TG	Detweiler, Robert C.	S Sgt	"
LWG	Dusenberry, Charles J.	S Sgt	"

Plane # 43-37628

P	Toussaint, Francis J.	1st Lt.	612th
CP	Beck, Walter H. Jr.	1st Lt.	"
N	Malone, John L.	2nd Lt.	"
B	Schmied, James W. Jr.	1st Lt.	"
RO	Likins, Robert W.	T Sgt	"
TTG	Greene, William R.	T Sgt	"
BTG	Minor, Wallace G.	S Sgt	"
TG	Hamer, Robert B.	S Sgt	"
LWG	McNicholas, Joseph D.	S Sgt	"

Plane # 42-102398

P	Harlan, Thomas J.	2nd Lt.	612th
CP	Thorne, Walter W.	2nd Lt.	"
N	Tarr, Charles Jr.	2nd Lt.	"
B	Pepper, James D.	T Sgt	"
RO	Robinson, Paul D.	T Sgt	"
TTG	Lee, Reed L.	T Sgt	"
BTG	Smith, Floyd G.	S Sgt	"
TG	Munford, John V.	S Sgt	"
LWG	Zaragoza, Albert R.	S Sgt	"

Plane # 42-39995

P	Gibson, Roger C.	2nd Lt.	612th
CP	Atkinson, William W.	2nd Lt.	"
BK	Kemler, Arden C.	2nd Lt.	"
N	Brand, George C.	2nd Lt.	"
RO	Heikkinen, Carl R.	T Sgt	"
TTG	Williamson, Joseph R.	T Sgt	"
BTG	Roethler, Roland V.	S Sgt	"
TG	King, Francis E. Jr.	S Sgt	"
LWG	Phelps, Durwood W.	S Sgt	"

Plane # 42-107039

P	Ludeman, Louis H.	1st Lt.	612th
CP	Holland, Martin C.	2nd Lt.	"
N	Hodowski, Bernard E.	2nd Lt.	"
B	Wolchick, Walter	F/O	"
RO	Robbins, Gene W.	Sgt	"
TTG	Smith, Nelson E.	S Sgt	"
BTG	Meyer, Gerald T.	Sgt	"
TG	Matanic, George P.	Sgt	"
LWG	Perkel, Max (NMI)	Sgt	"

OFFICE OF THE OPERATIONS OF THE
SIXTH Bombardment Squadron (H)

Plane # 42-37662

- P Cromer, Joseph L. 2nd Lt. 612th
- CP Trout, Ralph W. F/O
- N Phillips, Michael T. 2nd Lt. "
- B Waldhoff, Jack G. 1st Lt. "
- RO Goodman, Martin B. S Sgt
- TTG Stott, Douglas W. S Sgt
- BTG Coffin, Robert J. Jr. Sgt
- TG Villaigio, Vincent V. Sgt
- LWG Clark, Eugene F. Sgt

Plane # 42-102393

- P Mohler, Morris M. 2nd Lt. 612th
- CP Newcomb, 2nd Lt. "
- N Corwin, Herbert I. 2nd Lt. "
- B Kaczorowski, Henry A. 2nd Lt. "
- RO Stedman, Max D. Sgt
- TTG Litterell, Wallace G. S Sgt
- BTG Keyran, Pete P. Jr. Sgt
- TG Cloutier, Donald A. Sgt
- LWG Dunne, Patrick E. Sgt

~~Plane # 42-37790~~

- ~~P Schaunaman, George S. 2nd Lt. 612th~~
- ~~CP Hobgood, James R. 2nd Lt. "~~
- ~~N Sandoe, Kenneth E. 2nd Lt. "~~
- ~~B Curry, Edward A. Jr. Sgt~~
- ~~RO Kopitnikoff, Irving G. S Sgt~~
- ~~TTG Morris, Thomas P. S Sgt~~
- ~~BTG Willett, Edward H. Sgt~~
- ~~TG Williams, Clarence P. Sgt~~
- ~~LWG Smith, Harold W. Sgt~~

Plane # 42-106902 ~~42-37790~~

- P Loughlin, David (NMI) 1st Lt. 612th
- CP Meredith, Charles F. 2nd Lt. "
- B X Sdlak, Edwin F. 2nd Lt. "
- N Bernard, Roger L. 2nd Lt. "
- RO Sommers, James L. T Sgt
- TTG Livingston, Oliver E. T Sgt
- BTG Messex, David C. S Sgt
- TG Bailey, Albert M. S Sgt
- LWG Dralle, Arlo W. S Sgt

- 2nd Lt. "
- 2nd Lt. "
- 2nd Lt. "
- 2nd Lt. "
- T Sgt
- T Sgt
- S Sgt
- S Sgt
- S Sgt
- S Sgt

- 1st Lt. "
- 2nd Lt. "
- 2nd Lt. "
- F/O
- S Sgt
- S Sgt
- S Sgt
- S Sgt
- S Sgt
- S Sgt

613TH BOMBARDMENT SQUADRON (H)
 OFFICE OF THE OPERATIONS OFFICER
 AAF STATION 128, APO # 557

26 August 1944

LOADING LIST

<u>PLANE NO</u>	<u>DUTY</u>	<u>RANK</u>	<u>LAST NAME</u>	<u>FIRST NAME</u>	<u>MI</u>
44-6113	P	1st Lt.	MANNIX	WILLIAM	C.
	CP	2nd Lt.	COX	WILLIAM	E.
	H	1st Lt.	MALONEY	WILLIAM	F.
	B	P/O	ROSTROM	CARL	L.
	RO	T SGT.	THOMPSON	JOHN	S.
	TT	T SGT.	STOKESBERRY	THOMAS	R.
	BT	S SGT.	SCOTT	EDWARD	R.
	YG	S SGT.	EGGLESTON	HENRY	H.
	WG	S SGT.	PAVELSIN	JOSEPH	K.
42-31081	P	1st Lt.	KEELING	CHARLES	W.
	CP	1st Lt.	FRAZIER	DONALD	F.
	H	1st Lt.	WOLIVEN	IRVING	(HMI)
	B	2nd Lt.	JARDINE	JOHN	H.
	RO	T SGT.	CHARNES	HUGH	E.
	TT	T SGT.	FRIEST	MAURICE	C.
	BT	S SGT.	FREZ	FRANK	E.
	YG	S SGT.	PICO	WILLIAM	J.
	WG	S SGT.	GROSS	WILLIAM	J.

SIX HUNDRED AND FOURTEENTH BOMBARDMENT SQUADRON (H)
 FOUR HUNDRED AND FIRST BOMBARDMENT GROUP (H)
 Office of the Operations Officer

AAF Station # 128
 26 August 1944.

SUBJECT: Loading List.

TO : Operations Officer, 401st Bomb Gp (H), AAF Station # 128, APO # 557.

1. Following is the list of Combat Personnel participating in today's Mission.

PLANE 42-102659

P	1st Lt.	KOVACH, JOHN W.	614th
CP	2nd Lt.	KELLAM, JAMES W.	"
N	2nd Lt.	COSELLI, FRANK J. JR.	"
B	2nd Lt.	FLIEG, STANLEY W.	"
RO	T/Sgt.	Pollard, Omer S.	"
TT	T/Sgt.	Rouhselang, Willard J.	"
BT	S/Sgt.	Guest, Hollis D.	"
TG	S/Sgt.	Schmidt, Edward J.	"
WG	S/Sgt.	Haki, Arthur W.	"

PLANE 42-97602

P	1st Lt.	BRIGHT, WILBUR C.	"
CP	F/O	WITTMAN, PAUL F.	"
N	2nd Lt.	SCHNEIDER, JAMES M.	"
B	2nd Lt.	O'HERN, MELVIN C.	"
RO	T/Sgt.	Russell, James R.	"
TT	T/Sgt.	Tweed, Stanley A.	"
BT	S/Sgt.	Frohman, Howard J.	"
TG	Sgt.	Hayden, Andrew J.	"
WG	S/Sgt.	Jones, Scott D.	"

PLANE 42-97869

P	1st Lt.	EVANS, JACK B.	"
CP	1st Lt.	SCHULZ, JOHN	"
N	2nd Lt.	RHINEHART, WILLIAM E.	"
CTG	S/Sgt.	Shanks, Herbert H.	"
RO	T/Sgt.	Fidler, Charles K.	"
TT	S/Sgt.	Groce, Rudolph M.	"
BT	S/Sgt.	Spatilson, Bruno J.	"
TG	S/Sgt.	Smith, Malcolm F.	"
RG	S/Sgt.	Koehler, Earl E.	"

Loading List Con't:

PLANE 42-107084

P	2nd Lt.	MAYS, HAL C.	614th
CP	2nd Lt.	LIVINGSTON, HERMAN	"
N	2nd Lt.	KOSKI, MATTHEW F.	"
B	2nd Lt.	SCHAEFER, ROBERT L.	"
RO	Sgt.	Bayes, Willie J.	"
TT	Sgt.	Gay, Clifford E.	"
BT	Cpl.	Cole, William I.	"
TG	Cpl.	Monacella, Joseph L.	"
WG	Cpl.	Wilson, Billy J.	"

PLANE 42-97895

P	1st Lt.	KOONS, PAUL R.	614th Bomb Sq
CP	2nd Lt.	KAHAN, DANIEL	"
N	2nd Lt.	DOMROWOLSKI, EDWARD L.	"
EX B	1st Lt.	LE BLANC, JOHN S.	"
RO	T/Sgt.	McMinn, Thomas C.	"
TT	T/Sgt.	Shane, Charles	"
BT	S/Sgt.	Edwards, Rodney W.	"
TG	S/Sgt.	Huerta, Octavio	"
WG	S/Sgt.	Eckenrode, Robert T.	"

PLANE # 43-58125

P	Capt.	CRUMAN, JAMES A.	"
CP	1st Lt.	MELTON, LAVATA T.	"
N	1st Lt.	GRISSET, JACQUES	"
B	1st Lt.	ANDREWS, RICHARD J.	"
RO	T/Sgt.	Jacobson, Kenneth M.	"
EE	T/Sgt.	Snyder, Ernest M.	"
BT	S/Sgt.	Harwell, Wilton W.	"
TG	S/Sgt.	Ruhmann, Richard J.	"
WG	S/Sgt.	Kapbell Campbell, Davis H.	"

PLANE # 42-57652

P	1st Lt.	MERCER, ELMER W.	"
CP	2nd Lt.	HIBBERT, CARL D.	"
N	2nd Lt.	GASKINS, LESBIE E.	"
B	2nd Lt.	KLEFISCH, THEODORE J.	"
RO	T/sgt.	Zubricas, Joseph S.	"
TT	T/sgt.	Fowler, Cecil V.	"
BT	S/sgt.	Grasela, Edward B.	"
TG	S/sgt.	Gurnicki, Sigmund A.	"
WG	Sgt.	Connors, Robert A.	"

For the Squadron Commander:

BERNARD H. KAUFMAN,
 Capt., Air Corps,
 Asst. Opns. Officer.

PLANE # 42-102947

P 1st Lt.
 CP 2nd Lt.
 H 2nd Lt.
 CTG S/Sgt.
 RO S/Sgt.
 TT S/Sgt.
 BT S/Sgt.
 TG S/Sgt.
 WG ~~S/Sgt.~~ Cpl.

FILEMYR, GARRETT A.
 CLAXTON, HERBERT W.
 ROBINSON, EDWARD F.
 Tutwiler, David M.
 Parkes, James S.
 Moll, Robert C.
 Reynolds, William H.
 Culver, Malcolm J.
 Campbell, Thomas B.

64th Sq
 "
 "
 "
 "
 "
 "
 "
 "

SIX HUNDRED AND FIFTEENTH BOMBARDMENT SQUADRON (H)
 FOUR HUNDRED AND FIRST BOMBARDMENT GROUP (H)
 Office of the Operations Officer
 AAF - Sta - 128 - APO - 567

26 August 1944.

TO : Operations Officer, 401st Bomb Gp (H), Sta - 128 - APO - 567.
 FROM : [unclear]
 SUBJECT: Loading list.
 1. Following is the list of Combat Crews participating in today's mission.
 PLANE # 42-39780
 DUTY RANK LAST (NAME) FIRST (MI) SQUADRON

P	2nd Lt.	Charleville	Denver	R.	615th
CP	Captain	Kaliniski	Felix	A.	"
NO	2nd Lt.	Russell	Edwin	P.	"
NI	1st Lt.	Taylor	James	(MIL)	"
LI	2nd Lt.	Binnett	Charles	(MIL)	"
RO	E/Sgt.	MacKeller	Glenn	A.	"
TI	E/Sgt.	Hadden	Peter	S.	"
BT	S/Sgt.	Blodgett	Clifford	W.	"
TO	2nd Lt.	Swisher	Harold	P.	"
RG	Sgt. 1st	Davis	Thomas	(MIL)	612AF

PLANE # 43-36560

PO	2nd Lt.	Callaway	Robert	(MIL)	615th
CP	2nd Lt.	Lawson	Robert	S.	"
NO	2nd Lt.	Weiss	Herman	S.	"
LI	2nd Lt.	Griffin	Warren	S.	"
RO	E/Sgt.	Roberts	Melvin	(MIL)	"
TI	S/Sgt.	Southerland	James	(MIL)	"
BT	Sgt. 1st	Asheim	Arnold	C.	"
TO	Sgt. 1st	Pelz	Chester	C.	"
RG	Sgt. 1st	Trendelman	Frederick	S.	612AF

PLANE # 42-31691

PO	2nd Lt.	Cooper	Louis	E.	615th
CP	2nd Lt.	Spansel	Kaye	M.	"
NO	2nd Lt.	Ellis	George	O.	"
LI	2nd Lt.	D'Arostini	Benedict	R.	"
RO	S/Sgt.	Sherrill	Bascom	E.	"
TI	S/Sgt.	Sexton	Myron	W.	"
BT	Sgt. 1st	Maroncelli	Harry	J.	"
TO	Sgt. 1st	Lawrence	Ralph	I.	"
RG	Sgt. 1st	Gue	Charles	M.	612AF

DALL BVAK IVSL (NAME) AIBSL (MI) SQUADRON

PLANE # 44-0140

PLANE # 44-6148

DUTY	RANK	LAST (NAME)	FIRST	(MI)	SQUADRON
P	1st Lt.	Wingard	Milton	E.	615th
CP	2nd Lt.	Abresch	Robert	J.	"
N	2nd Lt.	Sullivan	Robert	E.	"
B	2nd Lt.	King	Willard	E.	"
RO	S/Sgt.	Cicogna	Ernest	G.	"
TT	S/Sgt.	Rutledge	James	C.	"
BT	Cpl.	Winzey	Patrick	H.	"
TG	Sgt.	Chiariello	Edward	A.	"
FG	Sgt.	Weiss	Joseph	M.	STAF

PLANE # ~~44-6310~~ 091

P	1st Lt.	Dow	Herbert	V.	615th
CP	2nd Lt.	Woodward	William	E.	"
Nh N	2nd Lt.	King	Robert	J.	"
B	S/Sgt.	Machasick	Alfred	(NMI)	"
RO	S/Sgt.	Carr	Gene	(NMI)	"
TT	S/Sgt.	Adams	Leroy	E.	"
BT	S/Sgt.	Macchietto	Richard	D.	"
TG	S/Sgt.	Sokolowski	Edward	A.	"
FG	S/Sgt.	Greenberg	Harald	(NMI)	STAF

PLANE # 43-33077

P	2nd Lt.	Haskett	Harry	(E)	615th
CP	2nd Lt.	Davis	Thomas	A.	"
N	2nd Lt.	Howze	Sturat	A.	"
B	2nd Lt.	Bavinghannan	Kenneth	D.	"
RO	S/Sgt.	Lynch	Brenden	J.	"
TT	S/Sgt.	Eudaley	Orville	A.	"
BT	Sgt.	Hitchinson	William	(D)	"
TG	Pvt.	Matts	Eudley	F.	"
FG	Sgt.	Jones	Hinson	C.	"
B	Sgt.	Decker	Decker	E.	STAF

Not fly

PLANE # ~~42-57332~~ 145

DUTY	RANK	LAST (NAME)	FIRST	(MI)	SQUADRON
P	2nd Lt.	Konze	Bodo	C.	615th
CP	2nd Lt.	Kolp	Norman	J. (io)	"
N	2nd Lt.	Stork	Oliver	L.	"
B	2nd Lt.	Kossuth	Alfred	G.	"
RO	T/Sgt.	Gratz	Robert	I	"
TT	S/Sgt.	Jones	William	D.	"
BT	S/Sgt.	Quigley	John	R.	"
TG	Sgt.	Jaranson	David	A.	"
FG	S/Sgt.	Kolster	Frederick	K.	"

OFFICE OF THE OBSERVATIONS OFFICER
 SIX HUNDRED AND FORTY SEVEN MILLSBORO ROAD MILLSBORO DELAWARE (H)
 SIX HUNDRED AND FORTY SEVEN MILLSBORO ROAD MILLSBORO DELAWARE (H)

SIX HUNDRED AND FIFTEENTH BOMBARDMENT SQUADRON (H)
 FOUR HUNDRED AND FIRST BOMBARDMENT GROUP (H)
 Office of the Operations Officer
 AAF - Sta - 128 - APO - 557

26 August 1944.

SUBJECT: Loading list. (Continued)

TO : Operations Officer, 401st Bomb Gp (H), Sta - 128 - APO - 557.

1. Following is the list of Combat Crews participating in today's mission.

PLANS # ~~42-51051~~ 468

DUTY	RANK	LAST (NAME)	FIRST	(MI)	SQUADRON
P	2nd Lt.	Udy	John	(NMI)	615th
CP	2nd Lt.	Hockaday	Billy	S.	"
N	2nd Lt.	McMahon	Oscar	R.	"
B	2nd Lt.	Youel	Daley	F.	"
RO	S/Sgt.	Knowles	Harry	G.	"
TI	S/Sgt.	Young	Jack	R.	"
BT	Sgt.	Albert	Russell	H.	"
TG	Sgt.	Warn	Ablert	E.	"
FG	Sgt.	Oviatt	Earl	D.	"

STATION WEATHER OFFICE
AAF STATION 128
APO 557 - U.S. ARMY

26 August 1944

WEATHER INTERROGATION SUMMARY FOR MISSION OF 26 AUGUST 1944.

BASE TAKE-OFF: 1500. 7/10 building cumulus base 3000'. 1/10 cirrus about 25000'. Visibility 3 miles with haze.

ROUTE OUT: 5-7/10 cumulus base 2-3000' tops 6-8000', decreasing to patchy 3-6/10 stratocumulus tops about 5-6000' over North Sea, and becoming 3-6/10 building cumulus tops 6-8000' occasionally 12-15000' over the continent. Nil middle cloud becoming 2-5/10 altostratus base 18000' tops 19-20000' and 2-4/10 altocumulus castellatus base 20-22000' tops 24-25000' 30 miles before reaching continental coast. Nil-2/10 cirrus at 25000' becoming 2-5/10 cirrus and cirrocumulus above 25000' over continent. Visibility unrestricted at altitude becoming 5-10 miles over continent.

TARGET: 1752. 3-6/10 building cumulus with tops to 12-15000'. 2-4/10 altostratus base 18000' tops 19-20000'. 2-4/10 altocumulus castellatus base 20-22000' tops 24-25000'. 2-4/10 cirrus and cirrocumulus above 25000'. Horizontal visibility 10 miles downsun and less than 5 miles upsun; vertical visibility less than 5 miles through haze.

RETURN ROUTE: Reverse of Route Out to England. Over England: Nil-3/10 cumulus base 3-4000' tops 5-6000'. Nil middle cloud becoming 1-3/10 altocumulus base 10-12000' in base area. Nil-3/10 cirrus above 25000'. Visibility unrestricted aloft becoming 5-10 miles on descent.

BASE ON RETURN: 1930. Trace of cumulus at 3000'. 3/10 altocumulus 10-12000'. 3/10 cirrus 25000'. Visibility 4 miles with haze.

REMARKS: Light non-persistent contrails at 17000' and 19000' (about 1000' below middle cloud layers) over continent. Haze layer extending to 8-10000'; haze moderate over England and North Sea but denser over continent. Temperatures as forecast, e.g., 16000' -7°, 19500' -13°. Winds were 5-10 knots stronger than forecast, e.g., 12000' 20k^o 25, 16000' 218° 25.

Walter J. Saucier
WALTER J. SAUCIER
1st Lt., Air Corps
Weather Officer

OPERATIONAL ROUTE FORECAST

DATE 26 Aug. '44
 PERIOD 1600-2100
AG P BR HQ SOS /22929

	A BASE TO TARGET	B TARGET TO BASE	C	D
WEATHER	1 Partly is cloudy to cloudy becoming partly cloudy.	Partly cloudy.	CONFIDENTIAL	
CLOUDS	2 3-5/10 cumulus base 3000 tops 5-7000 decreasing to nil-3/10 stratocu. base 1-2000 tops 3-4000 over North Sea increasing to 2-4/10 cumulus base 3000 tops 5-7000 over cont. Isolated cuulonimb. south of target area tops 30,000. Nil-3/10 cirrus above 23,000.	Reverse of A 2 except nil-3/10 cumulus base 3000 tops 5000 upon return.		NOTE: Nil contrails at flight level.
ICING	3 12,000 ft. Nil.	12,000 ft. Nil.		
VISIBILITY	4 6 plus over England. Unres. aloft. Downward vis. 20 mi. at target.	Same as A 4.		
HEIGHT	DIRECTION VELOCITY	DIRECTION VELOCITY	DIRECTION VELOCITY	DIRECTION VELOCITY
SURFACE	BASE TO TRGT. TEMP.			
5,000 FT	140 05 plus 20			
10,000 FT	170 10 " 10			
15,000 FT	210 15 " 04			
20,000 FT	200 20 minus 06			
25,000 FT	190 25 " 15			
30,000 FT	190 35 " 27			
	30,000 FT	190 50 " 39		

BASE ALTIMETER SETTING 30.33 TARGET SURFACE TEMP. plus 20 TARGET MEAN TEMP. +3
 TEMP. AT 20,000 FT. -15 TARGET SURFACE (PRESSURE-ALT) _____
 Pressure-Alt -360 ft. at sea level

DECLASSIFIED PER NND 745003
 BY AS NARA DATE 1/22/11